



**AMBER VALLEY
BOROUGH COUNCIL**

**Amber Valley Borough Council
Amber Valley (Public Footpath No. 80 – Parish of Ripley)
Public Path Diversion Order 2020**

PUBLIC PATH DIVERSION ORDER

TOWN AND COUNTRY PLANNING ACT 1990, SECTION 257

AMBER VALLEY (FOOTPATH NO. 80 – PARISH OF RIPLEY)

PUBLIC PATH DIVERSION ORDER 2020

This order is made by Amber Valley Borough Council under section 257 of the Town and Country Planning Act 1990 because it is satisfied that it is necessary to divert the footpath to which this order relates in order to enable development to be carried out in accordance with planning permission granted under Part III of the Town and Country Planning Act 1990 namely: Outline application for mixed use development, including residential and community uses, highway works and public open space (AVA/2012/0346, AVA/2016/1030 and AVA/2019/0252).

BY THIS ORDER

1. The footpath over the land shown by a bold black line on the attached map and described in Part 1 of the Schedule to this order ("the Schedule") shall be diverted as provided below.
2. There shall be created to the reasonable satisfaction of Amber Valley Borough Council an alternative highway for use as a replacement for the said footpath as provided in Part 2 of the Schedule and shown by bold black dashes on the attached map.
3. The diversion of the footpath shall have effect on the date on which Amber Valley Borough Council certify that the terms of Article 2 above have been complied with.
4. The following works shall be carried out in relation to the highway described in Part 2 of the Schedule:

Construction of a kerbed tarmac pavement to a width of 2 metres with 160mm Type 1 granular sub-base, 50mm AC20 dense bit base course, and 20mm AC6 dense surface course, all to the satisfaction of the Council.

5. Peter James Homes Limited of McCann House, 110 Nottingham Road, Chilwell Nottingham, NG9 6DQ is hereby required to pay the cost of carrying out the said works.
6. Where immediately before the date on which the footpath is stopped up there is apparatus under, in, on, over, along or across it belonging to statutory undertakers for the purpose of carrying on their undertaking, the undertakers shall continue to have the same rights in respect of the apparatus as they then had.

SCHEDULE

PART 1

DESCRIPTION OF EXISTING PATH OR WAY

Section of path as indicated on map	Position
-------------------------------------	----------

A-B	The whole width of the footpath from Point A (Grid Reference SK35844 52231) proceeding in a Northeast by north direction to Point B (Grid Reference SK35871 52267) for a distance of 46 metres or thereabouts
-----	---

PART 2

DESCRIPTION OF SITE OF ALTERNATIVE HIGHWAY

Section of path as indicated on map	Position
-------------------------------------	----------

B – C	The footpath from Point B (Grid Reference SK35871 52267) proceeding in a West-by South direction to Point C (Grid Reference SK35863 52265) for a distance of 8 metres or thereabouts
C – D	The footpath from Point C (Grid Reference SK35863 52265) proceeding in a South-southwest direction to Point D (Grid Reference SK35861 52256) for a distance of 9 metres or thereabouts
D – E	The footpath from Point D (Grid Reference SK35861 52256) proceeding in a generally South South-west direction to Point E (Grid Reference SK35846 52228) for a distance of 32 metres or thereabouts

The width of the alternative footpath shall be 2 metres.

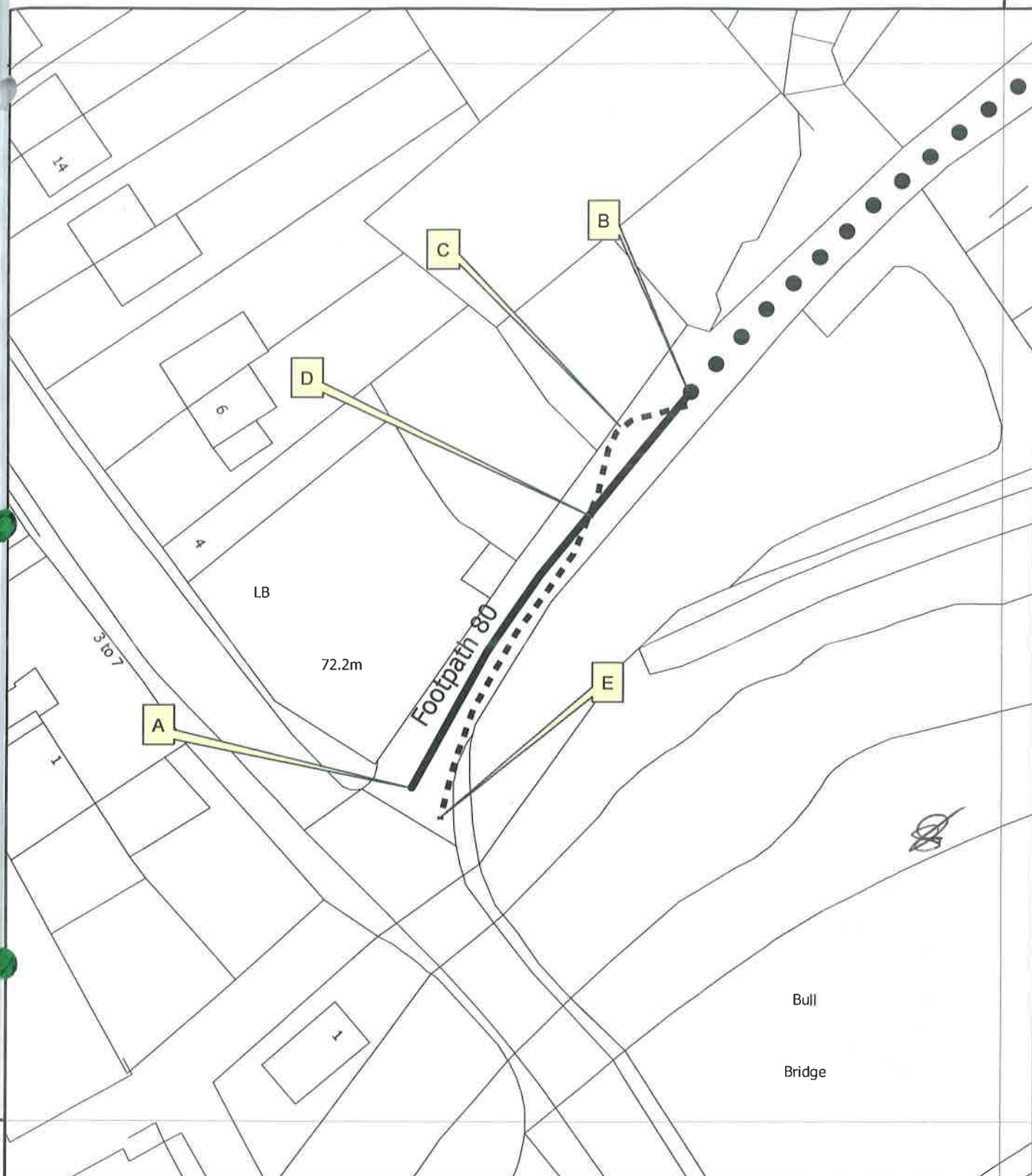

**AMBER VALLEY
BOROUGH COUNCIL**

Produced By
Executive Director (Resources)

Law and Assets
Town Hall
Market Place
Ripley
Derbyshire
DE5 3BT
Telephone (01773) 570222
Web www.ambervalley.gov.uk

Title:

Amber Valley Borough Council
Amber Valley (Public Footpath No. 80 - Parish of Ripley)
Public Bridleway Diversion Order 2019

Legend:

- Footpath to be diverted
- - - Proposed new Footpath
- ●

For identification purposes only

REPRODUCED FROM THE ORDNANCE SURVEY MAP
WITH THE PERMISSION OF THE CONTROLLER
OF HER MAJESTY'S STATIONERY OFFICE
© Crown Copyright 2019
ALL RIGHTS RESERVED. NO PART OF THIS PUBLICATION
MAY BE REPRODUCED OR TRANSMITTED IN ANY FORM
OR BY ANY MEANS, WITHOUT PERMISSION IN WRITING
FROM THE CONTROLLER.

Paper: @ A4
Scale: 1:500
Ref:
Drawn by: Stephen Knox
Date: 10 October 2019



Map Information:
ORDNANCE SURVEY
PLAN REF
EASTING
NORTHING
COUNTY
DISTRICT

435 854
352 235
DERBYSHIRE
AMBER VALLEY



The COMMON SEAL of the COUNCIL
OF THE BOROUGH OF AMBER VALLEY
was hereunto affixed this 1st day of July
2020 in the presence of: -



Mayor

Executive Director
(Resources) 

The foregoing Order is hereby confirmed by the Council of the Borough of Amber Valley as unopposed under Section 257 and Schedule 14 of the Town and Country Planning Act 1990 on this 1st day of October 2020.

Mayor

Executive Director
Resources) 